

## ALSAN RS Waterproofing with **ALSAN RS 230 Resin** for balcony end faces without guttering

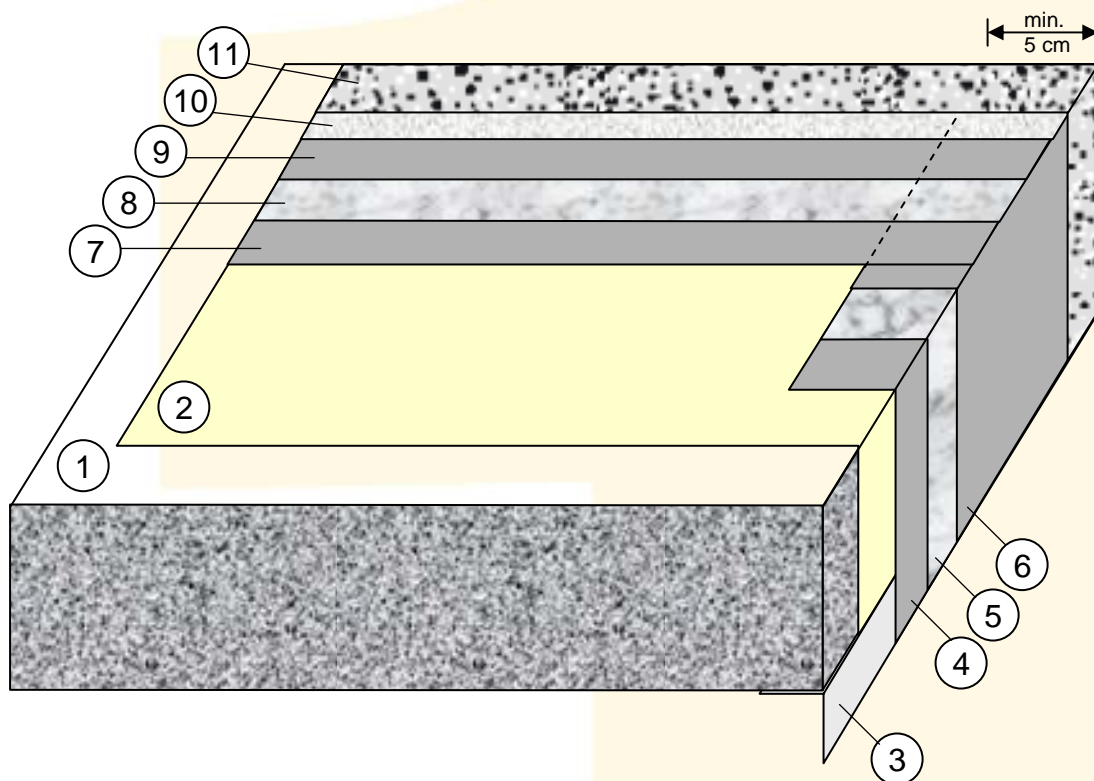

- 1 Mechanical pre-treatment of the substrate
- 2 **ALSAN RS 276 Primer**
- 3 PVC channel section as water drip (at least 2 x 2 cm)
- 4 **ALSAN RS 230 Resin** (thix, TT) fleece-embedding layer (approx. 2.00 kg/m<sup>2</sup>)
- 5 **ALSAN RS Fleece strip**
- 6 **ALSAN RS 230 Resin** (thix, TT) fleece-saturating layer (approx. 1.50 kg/m<sup>2</sup>)
- 7 **ALSAN RS 230 Resin** (thix, TT) fleece-embedding layer (approx. 2.00 kg/m<sup>2</sup>)
- 8 **ALSAN RS Fleece**
- 9 **ALSAN RS 230 Resin** (thix, TT) fleece-saturating layer (approx. 1.50 kg/m<sup>2</sup>)
- 10 **ALSAN RS 233 Self-Levelling Mortar** wear layer (approx. 4.50 kg/m<sup>2</sup>)
- 11 **ALSAN RS 288 Finish** (+ Chips as required)